

OFFICE COPY

ELEVATION

SECTION ON AB

WELL DETAIL

KEY PLAN (N.T.S)

SECTION COMPOUND WALL

Planning Permit No. **A/000579/350/2003**  
**APPROVED**  
 SUBJECT TO THE CONDITIONS IN THIS OFFICE LETTER.  
 No. **A/15563/03** Date **23-10-2003**  
 FOR MEMBER SECRETARY  
 CHENNAI METROPOLITAN  
 DEVELOPMENT AUTHORITY.  
 CHENNAI - 600 008.

PLAN SHOWING THE  
 PROPOSED BUILDING CONSTRU-  
 CTION OF S.NO:329/1C PART  
 D.NO:12/18, MUTHUMARI AMMAN

KOL STREET, LAKSHMI  
 PURAM, 103, THIRUNEER  
 MALAI VILLAGE,  
 C.No. **A/15563/2003**  
 TAMILNADU TALU Revised Plan  
 P.A.I. **14/10/2002**  
 KANCHEEPURAM DISTRICT  
 (THIRUNEER MALAI TOWN PANCHAYAT)  
 A 2 SCALE: D.S.O.

AREA DETAILS:-

	SQFT	SQ.M
PLOT EXTENT	2400	223.25
GROUND FLOOR AREA	1242	115.50
PLOT COVERAGE	51%	
F.S.I.	0.51	

JOINERY DETAILS:-

D - DOOR	= 3'3" x 7'0"
D <sub>i</sub> - DOOR	= 3'0" x 7'0"
W - WINDOW	= 4'6" x 4'6"
W <sub>i</sub> - WINDOW	= 4'0" x 4'6"
V - VENTILATOR	= 2'6" x 2'0"

COLOUR INDEX:-

PROPOSED	
ROAD	
BOUNDARY	

OWNER: **M.E. Govindarajulu**  
 (M.E. GOVINDA RAJULU)

Phone: **2401584**  
**R. JAYAVELU**  
 CIVIL ENGINEER  
 Licensed Surveyor  
 Alandur, Pallavaram Municipality  
 PAMMAL TOWN PANCHAYAT  
**JAYAM ENTERSES**  
 LICENSURE SURVEYOR:-  
 PALLAVARAM, CHENNAI 43

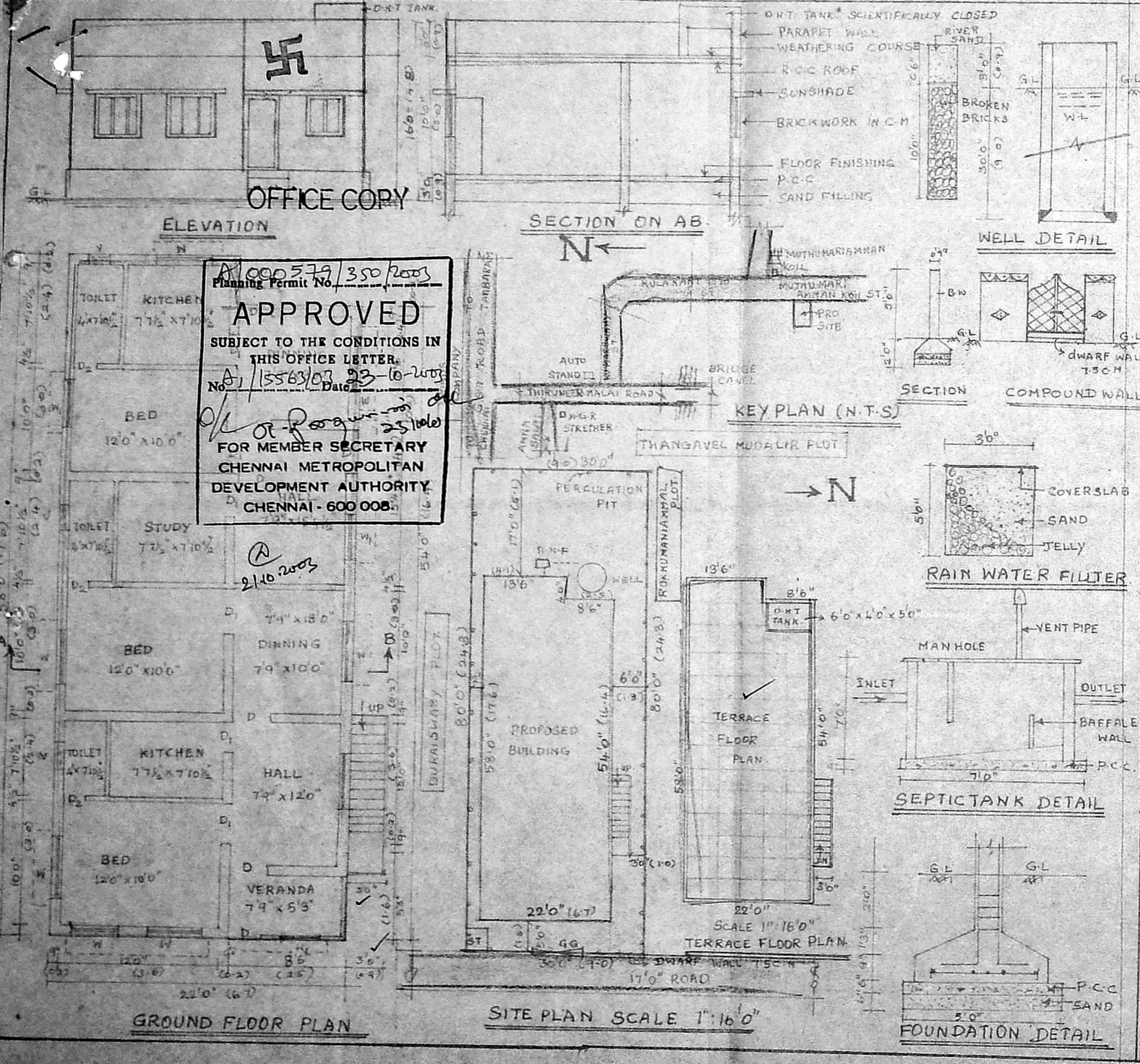

GROUND FLOOR PLAN

SITE PLAN SCALE 1"=16'0"

FOUNDATION DETAIL

D.NO: 22/22/03